

HARMONIX

EN

# SonaVue HJA Series



## Product Manual

HJA01-BLK

HJA02-BLK

HJA03-BLK 1.0d

HJA03-BLK 1.5d

HJA03-BLK 2.0d

## Product Specification

<b>Product Name:</b>	<b>SonaVue HJA Series</b>
Lenses:	Photochromatic Lenses
Color:	Clear through Gray
Filter:	Blue Light
Sunglasses UV protection:	Cat 2
Frame color:	Gloss Black Acetate
Version:	1.0
Bluetooth Version:	5.4
Transmission Distance:	≥ 12m
Glasses Battery Capacity:	100 mAh x 2
Usage Time:	+/- 10 hrs Streaming or +/- 8 hrs calls
Glasses Charging Time:	1.5 hrs
Water Resistance:	IP 54
Environmental Noise Cancellation:	3 Beamforming Microphones with advanced ENC for calls
Input:	5V 1A
Recharge Connection:	Magnetic connects via Type C USB Y Cable
Translation App:	AI Cool / AIP
App Requirements:	iOS 13 or Android 14.0 onwards
Case:	Fold out / Fold Flat Protective Case

### Contents

- 1x Pair of Glasses
- 1x USB C charging Y cable
- 1x Instruction booklet
- 1x Cleaning Cloth
- 1x User Guide

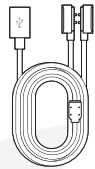

Y Shaped USB Cable



User Manual

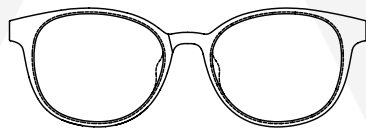

1x Pair of Glasses

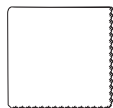

1x Cleaning Cloth



1x Case

## INTRODUCTION

Congratulations on choosing a pair of SonaVue HJA Audio Glasses. The following guide offers insights into how to get the best out of the glasses.

### Product Introduction

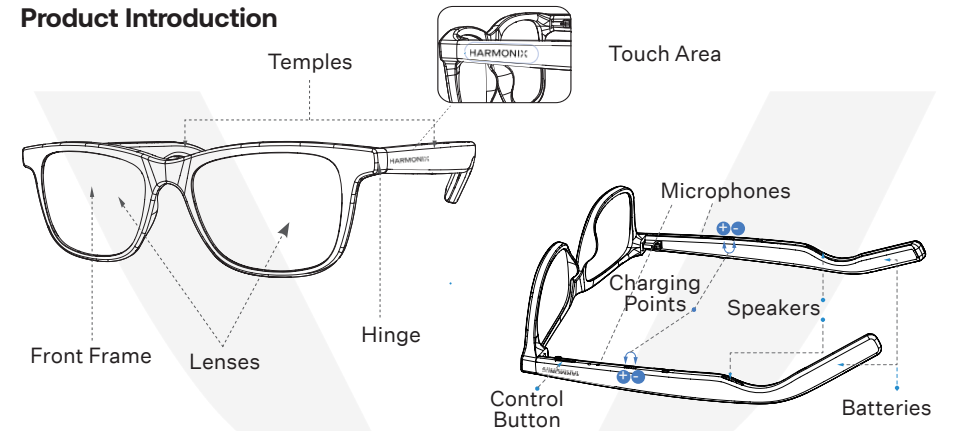

### Charging and Power Levels

A third party Type C male charging cable is required to charge the glasses. These are now shipped as standard with cellphones or most consumer electronics. Connect the magnetic charging cables as below. The indicator light shows red while charging and turns off when fully charged.

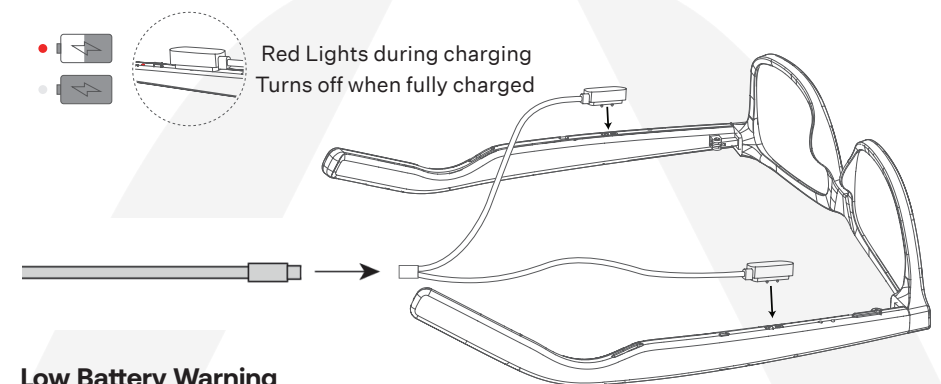

### Low Battery Warning

The glasses will announce "Battery Low" when they need recharging. The glasses will turn off on the 3rd warning announcement and require full charging.

## AUTO POWER ON

The glasses are fitted with a 3 array wear detector on each side for auto turn on. Make sure the glasses are fitted normally and not outside the ear.

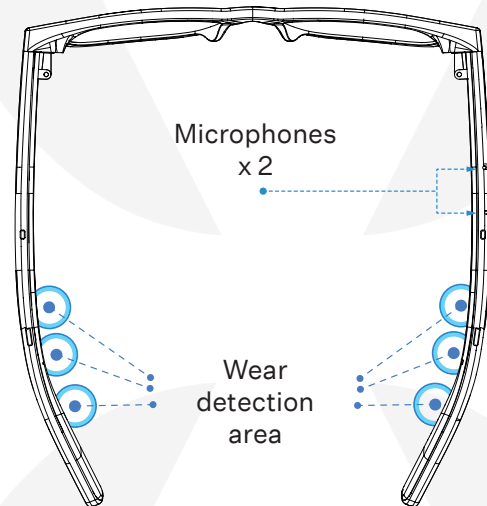
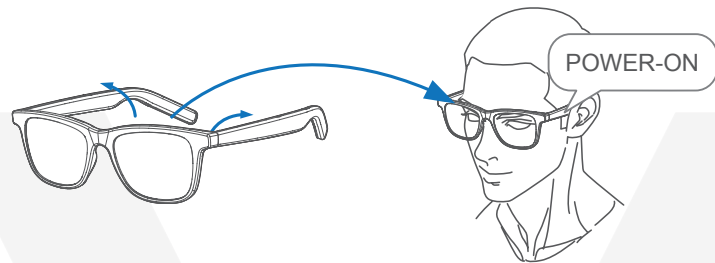

### Auto Turn on after charging

The glasses will auto shutdown during charging but automatically turn on when the cables are removed.

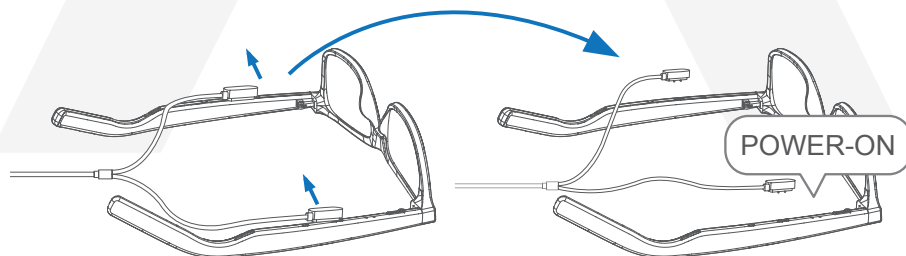

HARMONIX

harmonix.is  
harmonixhearing.com

## FIRST TIME PAIRING

Turn on the AI glasses and keep close to the smart device or computer.

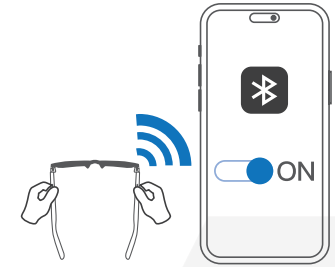

Open the settings on your device, turn on the bluetooth switch in the control centre.

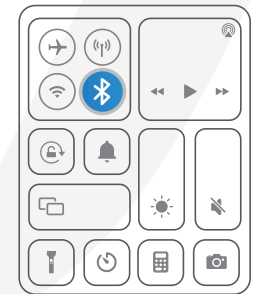

Search and click on the SonaVueHKA product details, you'll hear 'connected' once successful.

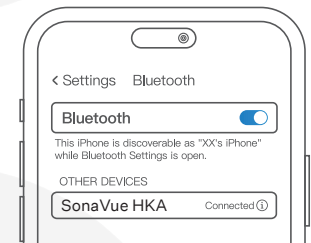

If pairing with another device, you should disconnect (not forget) the device from the device currently paired with. Alternatively turn off the Bluetooth on the current device.

### Manual Power Off

Press and hold the button under the right temple to power off the glasses.

### Audio Streaming when glasses are raised/removed

Any activity such as music/podcasts/calls will continue when the glasses are raised or removed. Press pause or move the stream back to the phone as necessary.

HARMONIX

harmonix.is  
harmonixhearing.com

## PHONE CALLS

### Answer Calls

Click on the control button under the right temple.

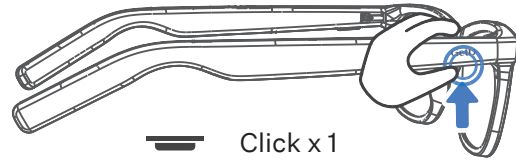

### Hang Up Calls

Double click either button under the temple

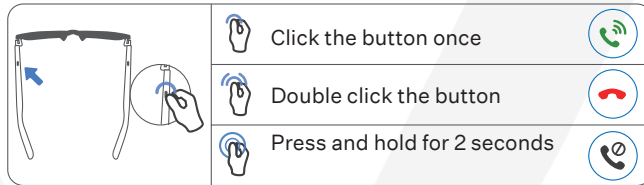

### Reject Calls

Press and hold the control button under the temple for 2 seconds.

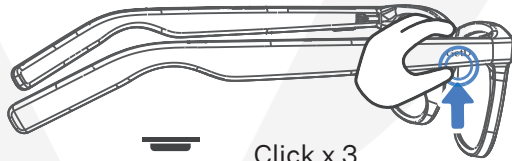

## TAKING PICTURES WITH CAMERA or SELFIE

Click the control button three times.

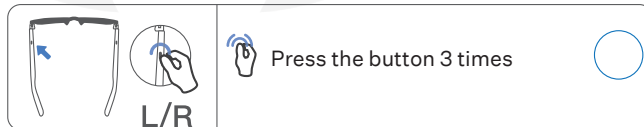

## VOICE ASSISTANT

Press and hold the control button under the right temple for 2 seconds to activate the voice assistant. (cannot be used when the glasses are taking phone calls)

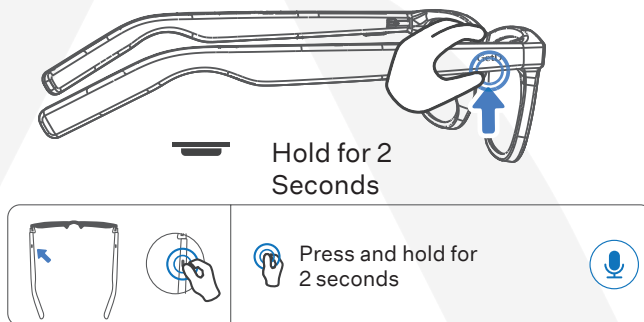

## VOLUME CONTROL

### Volume UP

Quickly swipe forward on the left temple touchpad.

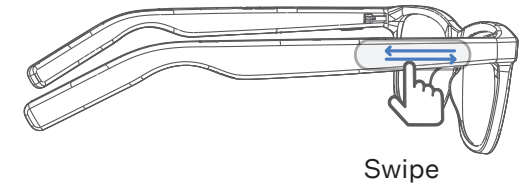

### Volume DOWN

Quickly swipe backwards on the left temple touchpad.

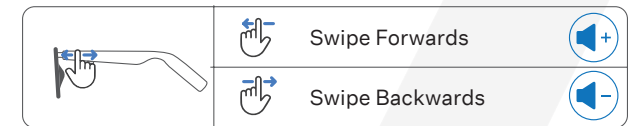

## TRACK CONTROL

### Next Track

Quickly swipe forward on the right temple touchpad.

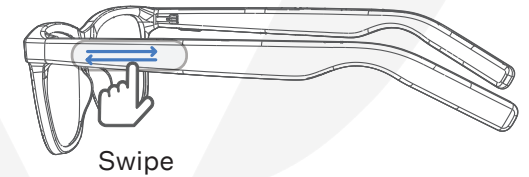

### Last Track

Quickly swipe backwards on the right temple touchpad.

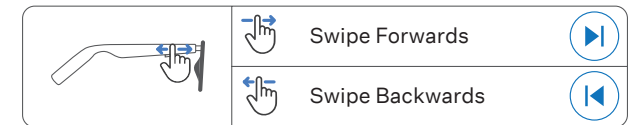

## PLAY/PAUSE

Press the button under the right temple to play or pause.

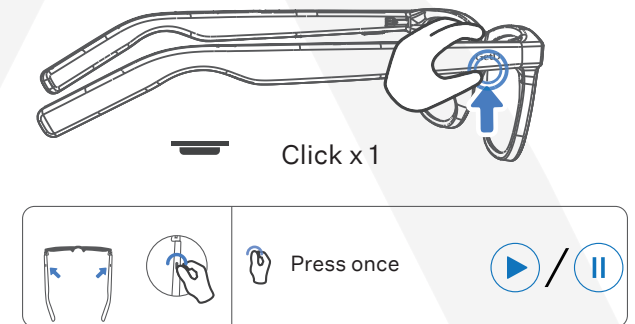

## iOS “Find my” setup

1. Holding the glasses upside down with the lenses closest to the body, hold the left hand arm (without button) for 3 seconds, then double press the button on the right side. This will activate a melody sound on the glasses. These are now ready to pair.

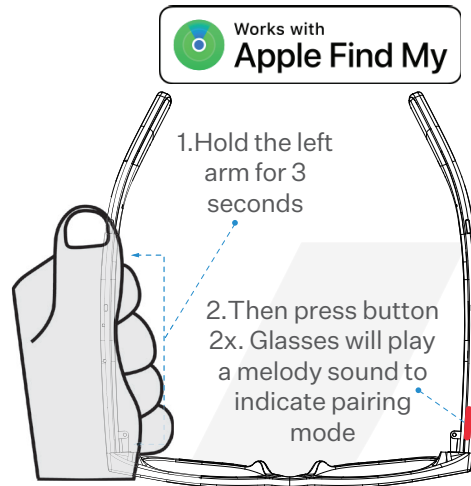

2. Open the “Find My” App on your iPhone and open the Items tab.

3. Press the + icon in the top corner and select “Other Item”. Your iPhone will search for compatible products.

4. Chose the SMART EYEWEAR and connect. Your glasses will now appear in the list of items. You can change the name and icon as any other item.

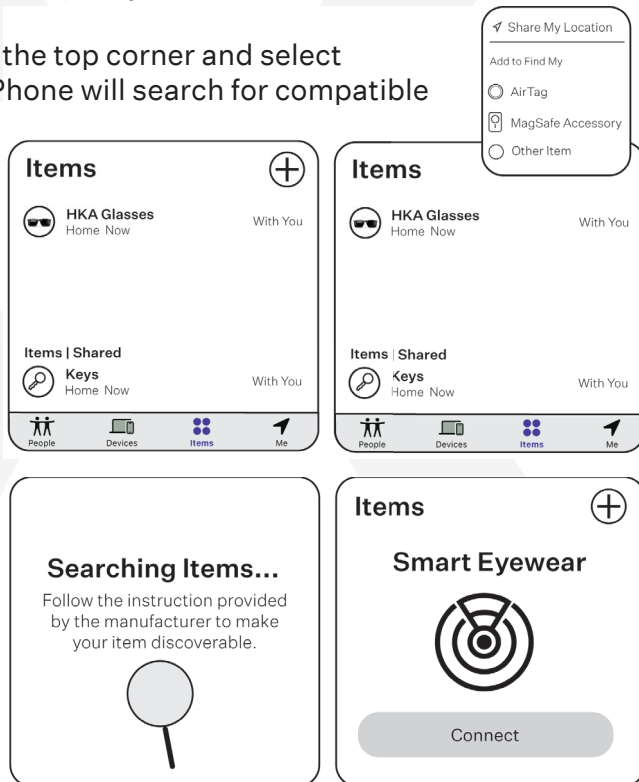

## AI Cool/AIP App Subscription - Included

### VIP Subscription Included

Thank you for purchasing from the SonaVue range of open ear glasses. Included in the product is a subscription to AI Cool/AIP translation software.



AIP Google Play AI Cool iOS

Download the APP from the link and simply open and pair via your Bluetooth settings if the device is not immediately found.

### Register via email

In order to use the software, an email account is required. A verification code will be sent to the email address, please add this quickly to ensure activation. The headphones are bound by the model number and then device MAC address.

Translation services are accessed through the “Simultaneous Interpretation” button.

(note that if the Bluetooth name is changed in settings the image of your glasses may disappear to a default)

AI Cool requires an active data service (5G preferred) or Wi-Fi connection to translate.

### Simultaneous Translation

Simultaneous Translation uses AI technology it pulls from the cloud. There is a slight delay depending on the performance of your device and the connection speed. Allow the device and buds to connect and start translation before opening into dialogue.

Pressing on each side will bring up the language choices.

Press on the green microphone button to start the listening and translation service.

Press the red button to stop.

### Choose your languages

Choose the languages you wish to translate to and from in the header and then chose how you want the translation to output. There are 3 choices.

Pressing on the speaker button on the bottom of the screen to change translation type.

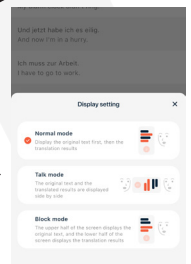
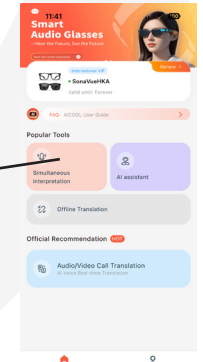

## Safety Instructions

1. To avoid hearing damage, do not use high volume for long periods of time.
2. Using harsh cleaning agents or unsuitable cleaning solutions may damage the lenses. Wipe the lenses with the original lens cloths or a clean, soft cloth. Use only mild, neutral cleaning solutions. Do not use abrasive cleaners, sprays, highly concentrated solvents, chemical cleaners, alcohol or acetone as they may damage, deform or discolor the frame, accessories or lenses.
3. Use the lenses at temperatures between 0°C and 45°C and store the lenses and accessories at normal temperatures. Extremely high or low temperatures may cause the device to malfunction.
4. Do not expose the lenses to direct sunlight for long periods of time as this may cause deformation, aging or breakage.
5. Do not expose the lenses to high temperatures. The battery may explode due to overheating.
6. Do not expose the glasses to liquids or immerse them in water.
7. Do not clean the glasses with alcohol.
8. Keep the glasses dry and avoid liquid splashes. Keep the glasses and their accessories away from rain and moisture. These glasses are not waterproof - do not wash the frames or use ultrasonic cleaning on them.
9. Do not heat or bend the frames as this may damage them and cause malfunctions.
10. The charger must comply with local standards to avoid malfunctions or damage. After charging, unplug the charger from the glasses and the power outlet. Do not allow the magnetic end of the charging cable to come into contact with metal objects to avoid a short circuit.
11. These glasses are not intended to protect against artificial light sources and cannot protect against mechanical shocks (such as optical glasses).
12. Heavy work with glasses can cause facial injury if the glasses break.
13. Some people may be allergic to materials such as plastic, metal, fibers or nylon. If symptoms such as redness, swelling or inflammation occur, stop using the product and consult a doctor.
14. To avoid interference from radio waves, maintain a distance of at least 15 cm from implanted or personal medical devices (such as pacemakers, cochlear implants, hearing aids, etc.).
15. Do not disassemble or modify the glasses or accessories (including replacing the built-in battery) without permission. Unauthorized actions will void the warranty. Contact customer service if any problems occur.
16. Dispose of the glasses, battery and accessories in accordance with local regulations. Do not treat them as household waste. Improper disposal may cause the battery to explode.
17. Please comply with local laws regarding the packaging and instructions for use of this product and support local recycling initiatives.



## WARNING

### California Proposition 65 Warning

**WARNING:** This product may contain chemicals, including [Lead, Phthalates, or Nickel]\*, which are known to the State of California to cause cancer, birth defects, or other reproductive harm.

For more information, visit [www.P65Warnings.ca.gov](http://www.P65Warnings.ca.gov)  
Harmonix provides this warning to comply with California's Proposition 65 law. The presence of a warning does not necessarily mean this product will cause harm. Our products meet all applicable federal safety standards. This notice is included out of an abundance of caution to ensure transparency for our customers.

Cancer and Reproductive Harm

[www.p65warnings.ca.gov](http://www.p65warnings.ca.gov)

# HARMONIX

harmonix.is  
harmonixhearing.com

## Storage and Maintenance

- This product should be stored in a cool and dry place. Operating temperature between 0~45° C.
- Keep the product away from heat sources, combustible gases, and other cleaning/corrosive liquids. Avoid prolonged sun exposure and use/placement in any high-temperature location.
- Stop using this product immediately if any parts are damaged or produce smoke, heat, or a burning smell.
- The speaker part of this product is not waterproof but is designed to be used in normal operating conditions. It is not specifically designed for contact sports where it may be impacted, get wet or immersed in water.
- The charging cable of this product is not waterproof. Do not expose the charging case to any liquids.
- Clean the earbuds with a soft dry cloth.
- After prolonged storage, recharge before use.

## Note

Design and specifications are subject to change without prior notice. For the latest company and product information, please visit [www.harmonix.is](http://www.harmonix.is)

## Hearing Damage

Listening to audio at excessive volumes may distort the sound and increase the risk of hearing damage and loss.

## FCC

FCC ID's: 2BT16-HKAHJA

## FCC Caution

Any changes or modifications not expressly approved by the party responsible for compliance could void the user's authority to operate the equipment. This device complies with Part 15 of the FCC Rules.

Operation is subject to the following two conditions:

- (1) this device may not cause harmful interference, and
- (2) this device must accept any interference received, including interference that may cause undesired operation.

## FCC Statement

This equipment has been tested and found to comply with the limits for a Class B digital device, pursuant to part 15 of the FCC Rules. These limits are designed to provide reasonable protection against harmful interference in a residential installation. This equipment generates, uses and can radiate radio frequency energy and, if not installed and used in accordance with the instructions, may cause harmful interference to radio communications. However, there is no guarantee that interference will not occur in a particular installation. If this equipment does cause harmful interference to radio or television reception, which can be determined by turning the equipment off and on, the user is encouraged to try to correct the interference by one or more of the following measures:

- Reorient or relocate the receiving antenna.
- Increase the separation between the equipment and receiver.
- Connect the equipment into an outlet on a circuit different from that to which the receiver is connected.
- Consult the dealer or an experienced radio/TV technician for help.

harmonix.is  
harmonixhearing.com

# HARMONIX

This equipment complies with FCC radiation exposure limits set forth for an uncontrolled environment. End user must follow the specific operating instructions for satisfying RF exposure compliance. This transmitter must not be co-located or operating in conjunction with any other antenna or transmitter. The portable device is designed to meet the requirements for exposure to radio waves established by the Federal Communications Commission (USA). These requirements set a SAR limit of 1.6 W/kg averaged over one gram of tissue.

Responsible party (contact for FCC matters only): Harmonix Technologies Inc., 200 Crandon Blvd., Key Biscayne, FL 33149.

#### **CE Declaration of Conformity**

Harmonix ehf. hereby declares that this product is in compliance with the essential requirements and other relevant provisions of Directive 2014/53/EU and all other applicable EU Directive requirements. The complete declaration of conformity can be found at: <https://harmonix.is/pages/doc>. Harmonix's EU representative is Harmonix ehf. Reykjavikurvegi 64, 220 Hafnarfjörður, Iceland.

Frequency Range: 2400-2483.5MHz  
Max. Transmit Power: 10 dBm(EIRP)

Directive 2014/53/EU radiation exposure statement:

This equipment complies with Directive 2014/53/EU radiation exposure limits set forth for an uncontrolled environment. End user must follow the specific operating instructions for satisfying RF exposure compliance. This transmitter must not be co-located or operating in conjunction with any other antenna or transmitter.

The portable device is designed to meet the requirements for exposure to radio waves established by European Union market. These requirements set a SAR limit of 2W/kg averaged over ten grams of tissue.

#### **WEEE Declaration of Conformity**

This WEEE logo means that this product must not be discarded as household waste, and should be delivered to an appropriate collection facility for recycling. Proper disposal and recycling helps protect natural resources, human health and the environment. For more information on disposal and recycling of this product, contact your local municipality, disposal service, or the shop where you bought this product.

#### **Disposal of electrical and electronic equipment**

The crossed-out dustbin means that you are legally obliged to collect these devices separately from unsorted municipal waste. Disposal via the residual waste bin or the yellow bin is prohibited. If the products contain batteries or rechargeable batteries that are not permanently installed, they must be removed and disposed of separately as a battery before disposal.

#### **Options for returning old devices**

Owners of old equipment can hand it in within the scope of the possibilities of returning or collecting old equipment set up and available by public waste management authorities in order to ensure proper disposal of the old equipment.

#### **Data protection**

We would like to point out to all end users of WEEE that you are responsible for deleting personal data on the WEEE to be disposed of.

#### **EU Declaration of Conformity**

HARMONIX EHF hereby declares that the devices of the type "SonaVue HJA Series", "SonaVue HKA Series" comply with the legal provisions of the General Product Safety Directive GPSR 2023/988/EU, the Radio Equipment Directive RED 2014/53/EU and the RoHS Directive 2011/65/EU. The full text of the EU declaration of conformity can be found on the following website. Web address: <https://harmonix.co/customerservice/>

#### **EU importer:**

Tekpoint GmbH  
Leopold Ungar Platz 2,A-1190 Vienna, Republic of Austria

#### **Battery**

##### **CAUTION**

- Replacement of a battery with an incorrect type that can defeat a safeguard.
- Disposal of a battery into fire or a hot oven, or mechanically crushing or cutting of a battery, that can result in an explosion.
- Leaving a battery in an extremely high temperature surrounding environment that can result in an explosion or the leakage of flammable liquid or gas.
- A battery subjected to extremely low air pressure that may result in an explosion or the leakage of flammable liquid or gas.
- Do not use the battery if it is noticeably expanded.

#### **Charging**

- Ensure the earbuds are dry before putting them into the charging case and keep the charging port dry before charging.
- Only use power adapters approved by relevant authorities and in compliance with local regulatory requirements (e.g., UL, CSA, VDE, CCC).

#### **Battery Manufacturer**

Shenzhen Mitacbattery Technology Co., Ltd.  
Building no 47, Kengwei Avenue, Shangwu Community, Shiyan Stree, Baoan District  
Shenzhen, Guangdong, PR China

- Ensure the earbuds are dry before putting them into the charging case and keep the charging port dry before charging.
- Only use power adapters approved by relevant authorities and in compliance with local regulatory requirements (e.g., UL, CSA, VDE, CCC).

#### **Dangerous Driving**

- Note that using this product while driving or cycling may violate regulations in some countries or regions. Verify and comply with traffic laws and regulations in your area and consult with local regulators.

#### **Skin Irritation**

- to a specific environment or long-term contact with soap, sweat, UV protection products, lotions, and other potentially irritating substances to the skin may cause allergic reactions.
- To reduce the risk of skin irritation, do not wear the product on any body parts with skin injuries.
  - Stop wearing the product immediately and consult your physician if your skin develops redness, swelling, itching, or any other irritating reaction.

### **Electromagnetic Interference**

- Do not use this product in places where wireless devices are prohibited (such as in airports and local medical facilities, etc.), as it may interfere with other electronic devices or cause other hazards.
- Some electronic devices may fail due to radio interference from this product (e.g., some automotive electronic equipment). Please contact the manufacturer of such electronic devices for more information.
- Radio waves generated by this product may affect the regular operation of some medical devices, such as pacemakers, defibrillators, cochlear implants, hearing aids, etc. If you use any of these medical devices, consult your physician and medical device manufacturer about restrictions service, or the shop where you bought this product.

### **Choking Hazard**

- Keep the glasses and charging case away from children and pets.

In case of accidental ingestion, seek immediate medical assistance.

### **Manufacturer's Warrant Statement:**

Harmonix provides a limited 12-month international warranty service (including USA) and 24-month warranty service for this product for products bought in the EU. For information on current warranties, visit our website: [www.harmonix.is](http://www.harmonix.is) or contact your seller. Ensure compliance with all local laws and regulations before using this product.

**Harmonix  
Customer Service  
Link**



**Harmonix ehf.**  
Reykjavíkurvegur 64-66,  
220 Hafnafjörður  
Iceland

**Harmonix Technologies LLC**  
200 Crandon Blvd.,  
Key Biscayne,  
FL 33149,  
USA

# HARMONIX

[harmonix.is](http://harmonix.is)  
[harmonixhearing.com](http://harmonixhearing.com)



## EU DECLARATION OF CONFORMITY

**Manufacturer:** Harmonix ehf.  
Reykjavikurvegi 64, 220 Hafnarfjordur, Iceland

**Place of Manufacture:** Shenzhen, Guangdong Province, China

**Product Family:** Harmonix SonaVue Jona Audio Glasses

**Models Covered:** **SonaVue Jona Series**

### Product Description:

Bluetooth-enabled smart audio eyewear incorporating open-ear audio technology, wireless music playback, voice communications and mobile device connectivity.

### Sku Codes Covered:

HJA01-BLK	HJA01-TOR
HJA02-BLK	HJA02-TOR
HJA03-BLK 1.0d	HJA03-TOR 1.0d
HJA03-BLK 1.5d	HJA03-TOR 1.5d
HJA03-BLK 2.0d	HJA03-TOR 2.0d

and any derivative models using the same electronic architecture and radio platform

### Revision History

No.	Date	Description of change	Version
1	2026.01.03	First issued	V1.0
2	2026.05.15	Updated Certification	V1.1

Harmonix ehf acts as the Manufacturer of Record for the products covered by this declaration and maintains the corresponding Technical Documentation.

**Harmonix ehf.**  
Reykjavikurvegi 64,  
220 Hafnarfjordur,  
Iceland

harmonix.co  
harmonixhearing.com



## Applied Standards & Common Specifications:

- Radio Equipment Directive (RED) 2014/53/EU
- RoHS Directive 2011/65/EU as amended by Directive (EU) 2015/863
- REACH Regulation (EC) No 1907/2006
- Battery Regulation (EU) 2023/1542
- General Product Safety Regulation (EU) 2023/988

## Radio Equipment Directive (RED) 2014/53/EU Certificate Number: BKC26052621EC

Document Number	Title of Document
EN 301 489-1 Ver. 2.2.3 (2019-11)	ElectroMagnetic Compatibility (EMC) standard for radio equipment and services; Part 1: Common technical requirements; Harmonised Standard for ElectroMagnetic Compatibility
EN 301 489-17 Ver. 3.2.4 (2020-09)	ElectroMagnetic Compatibility (EMC) standard for radio equipment and services; Part 17: Specific conditions for Broadband Data Transmission Systems; Harmonised Standard for ElectroMagnetic Compatibility
ETSI EN 300 328 V2.2.2 ( 2019-07 )	Wideband transmission systems; Data transmission equipment operating in the 2,4 GHz band; Harmonised Standard for access to radio spectrum
EN 62479:2010	Assessment of the compliance of low power electronic and electrical equipment with the basic restrictions related to human exposure to electromagnetic fields (10 MHz to 300 GHz)



**Restriction of the use of certain hazardous substances RoHS 2.0 Directive  
2011/65/EU Annex II (EU) 2015/863 as last amended by Directive (EU) 2017/2102**

**Certificate Number:**

**Black Frames                      BKC26052622ER**  
**Tortoiseshell Frames        BKC26052623ER**

Standard	Full Title
<b>EN 62321-3-1:2013</b>	Determination of certain substances in electrotechnical products – Part 3-1: Screening – Lead, mercury, cadmium, total chromium and total bromine by X-ray fluorescence spectrometry (XRF)
<b>EN 62321-4:2013+A1:2017</b>	Determination of certain substances in electrotechnical products – Part 4: Mercury in polymers, metals and electronics by CV-AAS, CV-AFS, ICP-OES and ICP-MS
<b>EN 62321-5:2013</b>	Determination of certain substances in electrotechnical products – Part 5: Cadmium, lead and chromium in polymers and electronics and cadmium and lead in metals by AAS, AFS, ICP-OES and ICP-MS
<b>EN 62321-6:2015</b>	Determination of certain substances in electrotechnical products – Part 6: Polybrominated biphenyls (PBBs) and polybrominated diphenyl ethers (PBDEs) in polymers by gas chromatography-mass spectrometry (GC-MS)
<b>EN 62321-7-1:2015</b>	Determination of certain substances in electrotechnical products – Part 7-1: Hexavalent chromium (Cr(VI)) in colourless and coloured corrosion-protected coatings on metals by colorimetric method
<b>EN 62321-7-2:2017</b>	Determination of certain substances in electrotechnical products – Part 7-2: Hexavalent chromium (Cr(VI)) in polymers and electronics by colorimetric method
<b>EN 62321-8:2017</b>	Determination of certain substances in electrotechnical products – Part 8: Phthalates in polymers by gas chromatography-mass spectrometry (GC-MS), gas chromatography-mass spectrometry using thermal desorption (TD-GC-MS) and liquid chromatography-mass spectrometry (LC-MS)

## Optical Product Requirements

The optical components of the product have been designed and manufactured in accordance with the requirements of EN ISO 12312-1:2022 and/or EN 14139:2010, as applicable to the model variant.



## Conformity Statement:

We hereby declare under our sole responsibility that the products identified in this declaration conform to the applicable requirements of the legislation and standards referenced herein. All relevant safety, EMC, RF exposure, radio spectrum and environmental compliance reports are maintained within the Technical Documentation.

We take full responsibility for the conformity of this product. Technical construction files are available for inspection by relevant European official authorities.

Signature : 

Authorized Signatory      Stuart McAdam  
Date:                              15<sup>th</sup> May 2026  
Position:                        Chief Operating Officer (COO)  
Place:                             Hafnarfjordur, Iceland





## SonaVue Global Regulatory Compliance Statement Annex A – Optical Lenses

The optical components of the product have been designed and manufactured in accordance with the requirements of EN ISO 12312-1:2022 and/or EN 14139:2010, as applicable to the model variant.

Model	Description	Lens Type	Standard
HJA01-BLK HJA01-TOR	Audio Glasses	Photochromic Lens	EN ISO 12312-1
HJA02-BLK HJA02-TOR	Audio Sunglasses	Polarised Sun Lens	EN ISO 12312-1
HJA03-BLK 1.0d HJA03-TOR 1.0d	Audio Reader	Photochromatic Lens +1.0 dioptr progressive reader	EN ISO 12312-1 EN 14139
HJA03-BLK 1.5d HJA03-TOR 1.5d	Audio Reader	Photochromatic Lens +1.5 dioptr progressive reader	EN ISO 12312-1 EN 14139
HJA03-BLK 2.0d HJA03-TOR 2.0d	Audio Reader	Photochromatic Lens +2.0 dioptr progressive reader	EN ISO 12312-1 EN 14139

Product	Lens Category
HJA01 Photochromic	Category 0–3
HJA02 Sunglasses	Category 3
HJA03 Reader variants	Category 0–3

In addition, lens assemblies used within the SonaVue Jona product family have been independently tested and found compliant with:

- ANSI Z80.3:2018
- EN ISO 12312-1:2022
- AS/NZS 1067.1:2016

### Lens Performance Characteristics

- UV400 protection
- UVA and UVB protection
- Traffic signal recognition compliant
- Polarisation (where applicable)
- Photochromic category 0–3 (where applicable)
- Blue Light Filtration (where applicable)

**Harmonix ehf.**  
Reykjavíkurvegi 64,  
220 Hafnarfjörður,  
Iceland

harmonix.co  
harmonixhearing.com



## Lens Performance Summary

Model	Description	Lens Type	Filter Category	Lens Category
HJA01-BLK HJA01-TOR	Audio Glasses	Photochromic Lens	Clear – 0 Dark - 3	Clear – 0 Dark - 3
HJA02-BLK HJA02-TOR	Audio Sunglasses	Polarised Sun Lens	3	3
HJA03-BLK 1.0d HJA03-TOR 1.0d	Audio Progressive Reader	Photochromatic Lens +1.0 dioptrre progressive reader	Clear – 0 Dark - 3	Clear – 0 Dark - 3
HJA03-BLK 1.5d HJA03-TOR 1.5d	Audio Progressive Reader	Photochromatic Lens +1.5 dioptrre progressive reader	Clear – 0 Dark - 3	Clear – 0 Dark - 3
HJA03-BLK 2.0d HJA03-TOR 2.0d	Audio Progressive Reader	Photochromatic Lens +2.0 dioptrre progressive reader	Clear – 0 Dark - 3	Clear – 0 Dark - 3

## Annex B – FCC Requirements

### FCC ID – 2BTI6-HKAHJA

#### Regulatory Compliance

- FCC Part 15 Subpart C
- FCC RF Exposure Requirements (KDB 447498)

#### Safety

- UL 62368-1
- UL 1642
- UL 2054
- UN38.3

#### Environmental

- RoHS 2011/65/EU
- REACH SVHC
- California Proposition 65

#### Optical

- ANSI Z80.3-2018 (Sunglasses)
- ANSI Z80.17 (Ready-Made Readers)



## Annex C – Technical Documentation Reference

Item	Reference
RED Test Report	BKC26052621EC
RoHS Report (Black)	BKC26052622ER
RoHS Report (Tortoiseshell)	BKC26052623ER
FCC	BKC25104377KE
User Instructions	Latest Revision
Risk Assessment	HMX-RA-SV-001
Product Specification	Harmonix_SmartGlasses_PRD_v1.1_June_2025

## Annex D – Battery & Transport Compliance

### Battery Specification

The SonaVue Jona product family incorporates a rechargeable Lithium-Ion Polymer battery manufactured by Shenzhen Mitac Battery Technology Co., Ltd.

Battery Model:	400735
Battery Type:	Single Cell Lithium-Ion Polymer Battery x2
Nominal Voltage:	3.8V
Rated Capacity:	100mAh x2
Rated Energy:	0.38Wh x2
Battery Weight:	1.85g x2
Battery Dimensions:	36.6mm × 6.8mm × 3.9mm

### UN38.3 Transport Testing

The battery has been tested in accordance with:

UN Manual of Tests and Criteria  
ST/SG/AC.10/11/Rev.8  
Section 38.3

**Test Report Number:** ZKT-250610L12892S

The battery successfully passed:

- T.1 Altitude Simulation
- T.2 Thermal Test
- T.3 Vibration
- T.4 Shock
- T.5 External Short Circuit
- T.6 Crush
- T.7 Overcharge
- T.8 Forced Discharge

**Harmonix ehf.**  
Reykjavíkurvegi 64,  
220 Hafnarfjörður,  
Iceland

harmonix.co  
harmonixhearing.com



## Transport Compliance

The battery has been assessed for international transport and is suitable for shipment in accordance with applicable lithium battery transport regulations.

### Supporting Documentation:

- UN38.3 Test Report ZKT-250610L12892S
- UN38.3 Test Summary ZKT-250610L12892S
- Material Safety Data Sheet (MSDS) ZKT-250610L12893S
- 1.2m Package Drop Test Report ZKT-250610L12894S
- 3m Stacking Test Report ZKT-250610L12895S
- Marine Transport Classification Report ZKT-250610L12896S

### Packaging Validation

Battery packaging has successfully passed:

- 1.2 metre package drop testing
- 3 metre stacking test requirements
- Transport packaging evaluation for air and marine shipment

The battery and packaging system comply with the applicable transport provisions for lithium-ion batteries and are maintained within the Harmonix technical documentation file.

End of Declaration